

EMERGENCY EVACUATION PLAN



ASCC Security Office Management
(PFM Department)

INTRODUCTION

The American Samoa Community College (ASCC) Emergency Operations Plan provides procedures for managing and responding to major emergencies that may threaten the health and safety of the campus community or disrupt its programs and activities.

AUTHORITY

The Emergency Operations Plan is declared under the authority of the President of the American Samoa Community College

EMERGENCY PLAN CONCEPT OR OPERATIONS

The evacuation plan is designed to provide an organized management system for the ASCC campus to follow during times of emergencies. The system is flexible where parts of or the entire plan may be activated, as appropriate to the situation.

SITUATIONAL REQUIREMENT

EMERGENCY CLASSIFICATION- Each incident will be classified by Type According to its potential impact, severity and response requirement.

TYPE 1- Minor Incident

- This incident is localized in nature or contained in a small area.
- It can be quickly revolved with existing campus resources or limited outside help.
- Have little or no impact on personnel or normal operations outside of the affected area.
- No campus notification for assisted action is required.

EXAMPLES OF TYPE 1: Odor complaints; localized chemical spills; plumbing Failures; water leak and etc...

Type 2- Emergency

- Type 2 incidents disrupt a sizeable portion of the campus community.
- Require assistance from external organizations.
- Can escalated quickly and have serious consequences for mission-critical functions and/or life and safety.
- Emergency contacts for ASCC are to be notified when possible

Type 2 Emergency Examples:

- Building fire or explosion
- Biological or terrorist threat
- Major chemical or hazardous spills
- Severe storm or flooding
- Extensive utility outage
- Off-campus emergencies that may impact campus operations or personnel

Type 3- Disaster

- Involve in a large part of the campus and its surrounding community.
- Normal campus operations are curtailed or suspended.
- The effects of the disaster are wide-ranging and complex.
- A timely resolution of disaster conditions requires campus-wide cooperation and extensive coordination and support from external jurisdictions.
- Emergency contacts for ASCC are to be notified when possible

TYPE 3 Disaster Examples:

- Major earthquake
- Terrorist attack
- Biological outbreak, pandemic
- Civil disturbance

EVACUATION PROCEDURES

Evacuation from the Administrative Building

1. Proceed to the Parking Lot through main front corridor.
2. Proceed to the Malae Area.

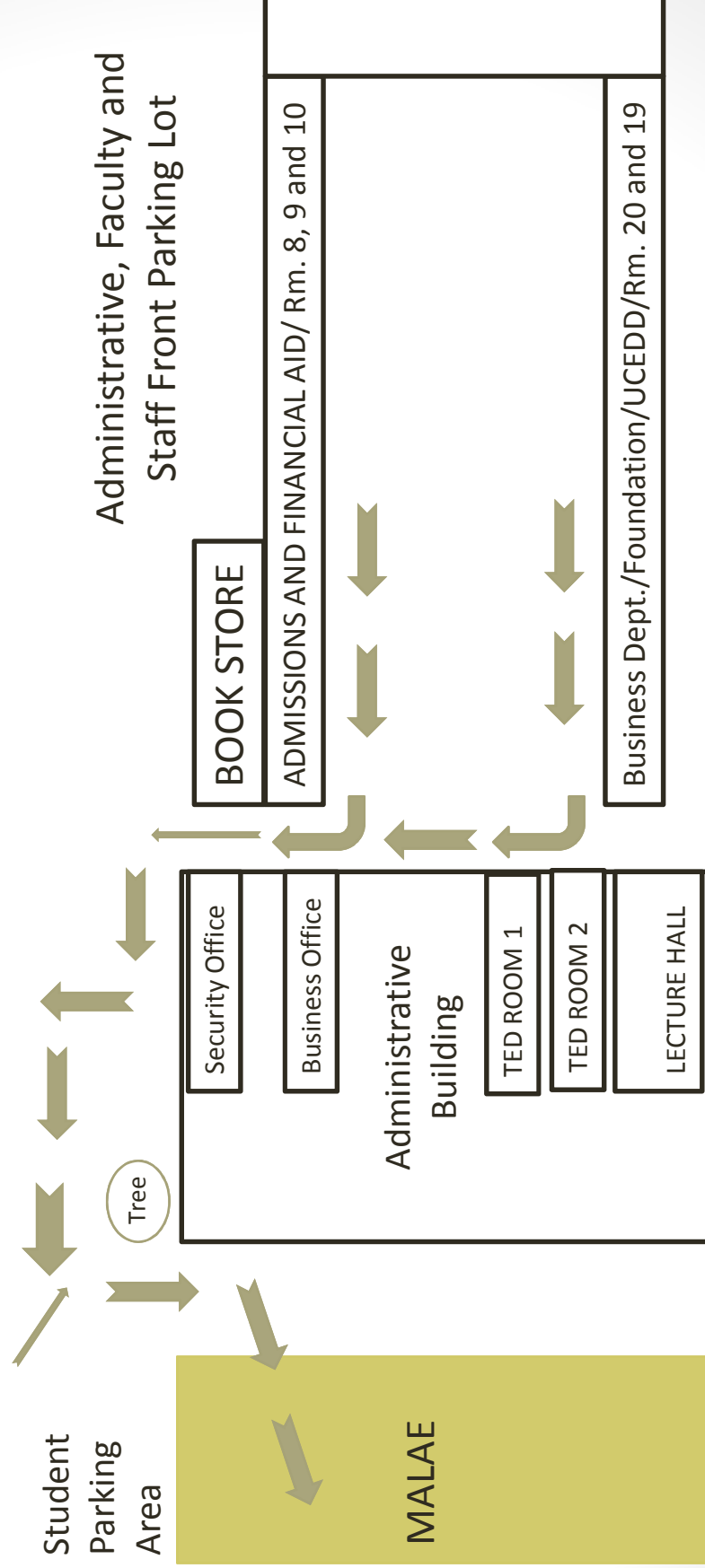

EVACUATION PROCEDURES

Evacuation from the Quad Area

1. Proceed through Lecture Hall way to the Malae Area
2. Proceed through ASTEP door and turn left to the front Parking Lot

Student
Parking
Area

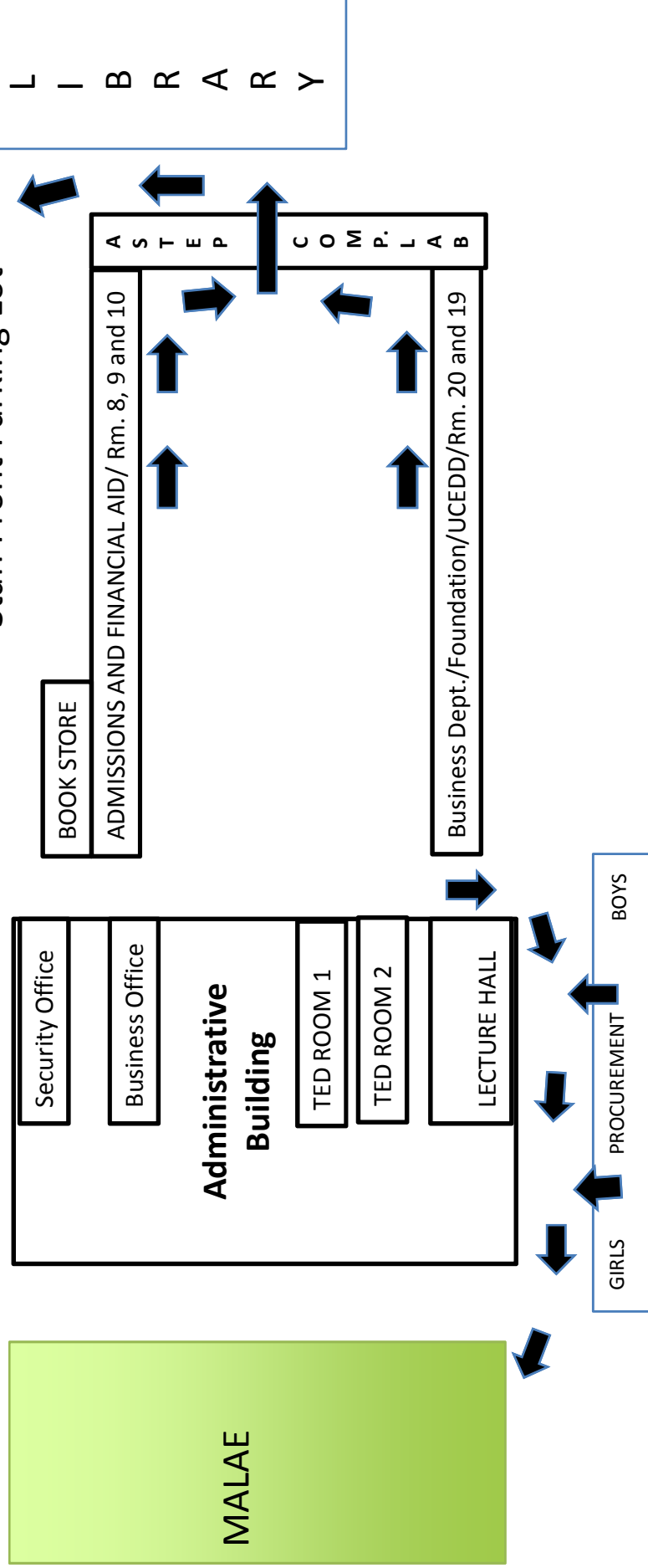

EVACUATION PROCEDURES

Evacuation from the Science Buildings

1. Proceed through steps to Annex area and to the Malae Area.
1. Proceed through steps to ELI/CAP Building area and up to the Housing Road

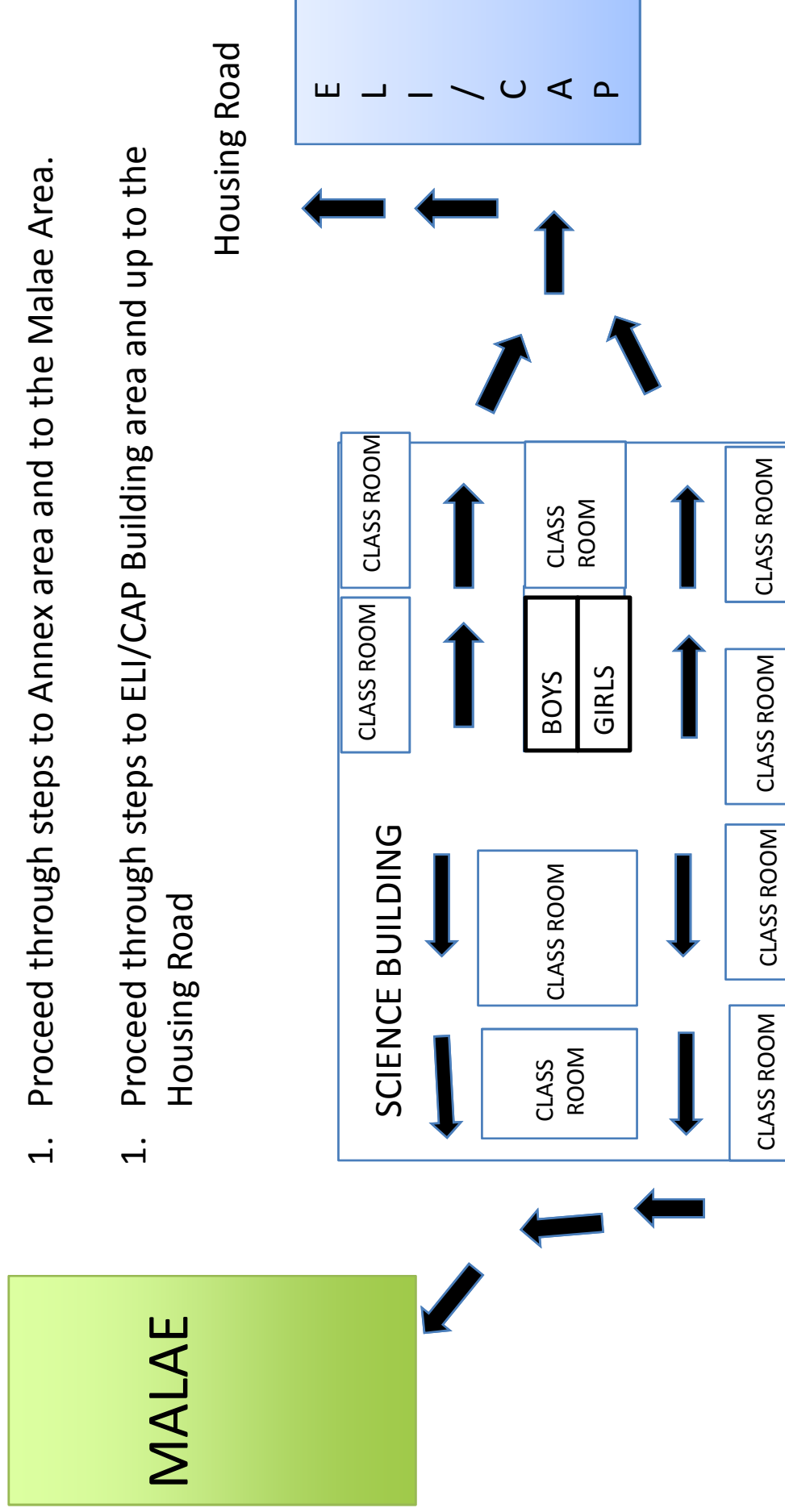

EVACUATION PROCEDURES

Evacuation at the ANNEX Area

1. Proceed directly to Malae Area from classroom and office.
1. Proceed to Cafeteria ramp and towards Cafeteria Parking Area.

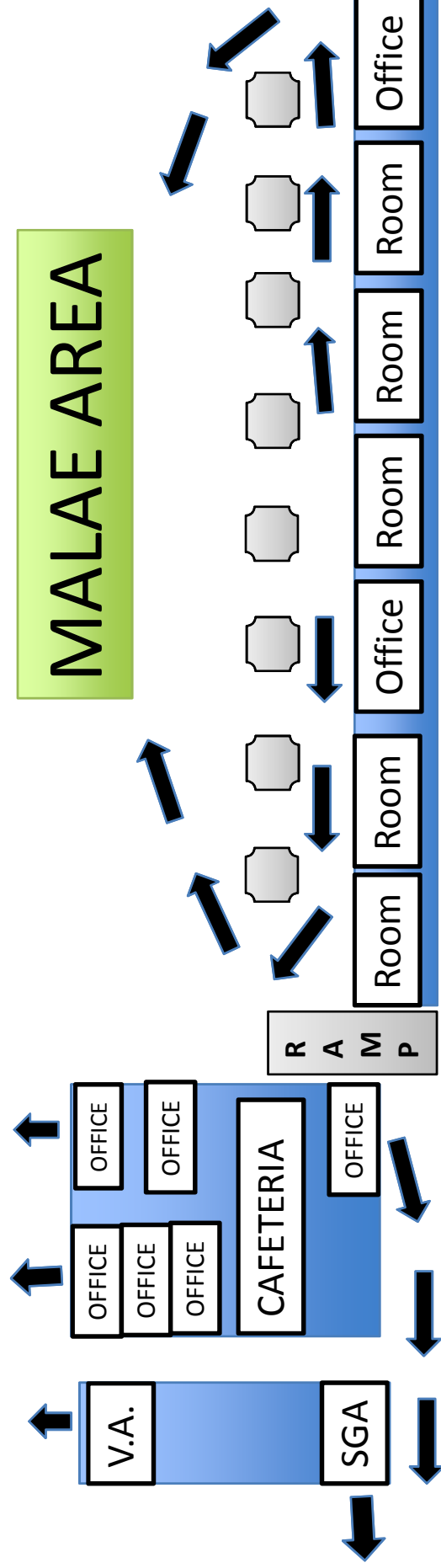

EVACUATION PROCEDURES

Evacuation from the Cafeteria & Art Building

1. Proceed through Annex Hall way to the Malae Area
2. Proceed directly to Cafeteria Parking Area.

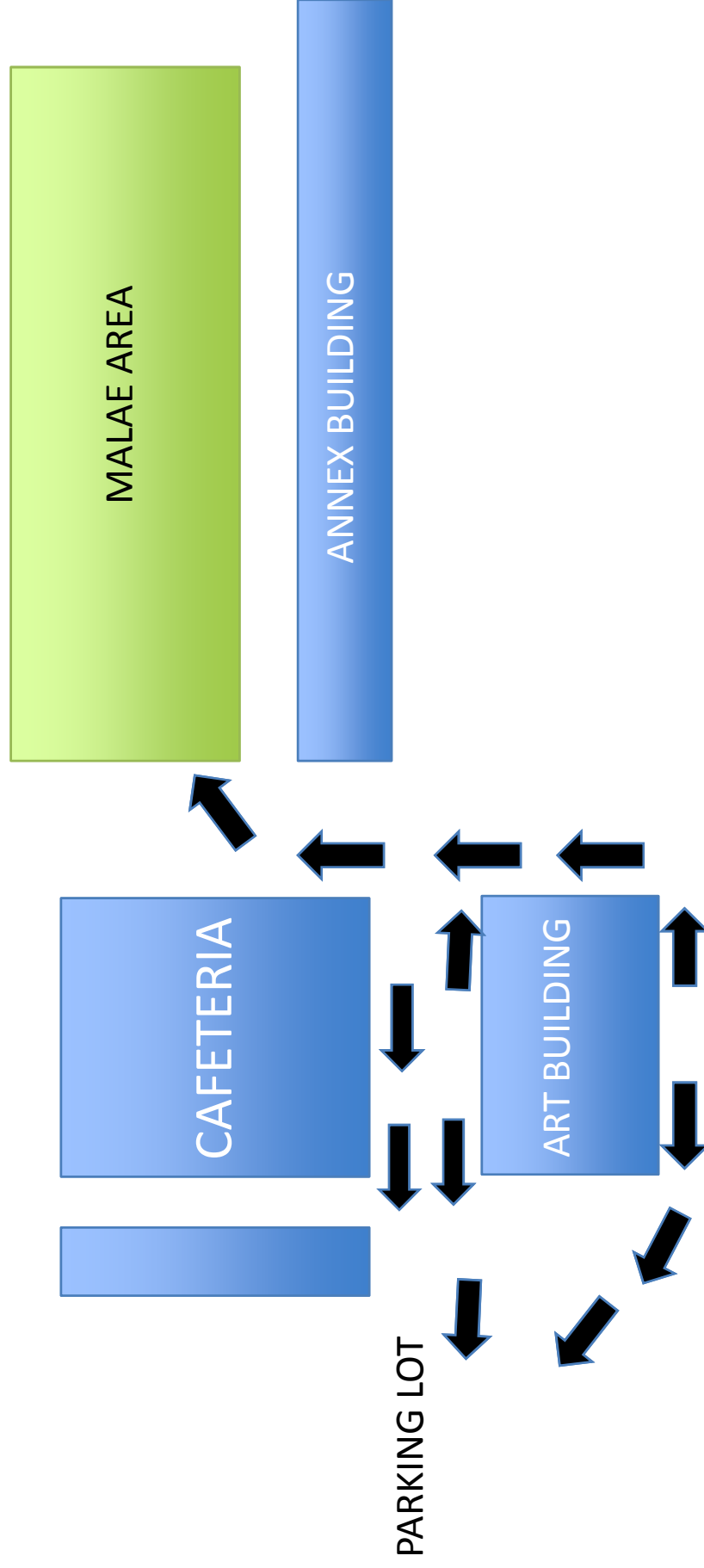

EVACUATION PROCEDURES

Evacuation from the Library & ELI Building

1. Proceed to hillside sidewalk by M-11 directly to Front Parking Lot.

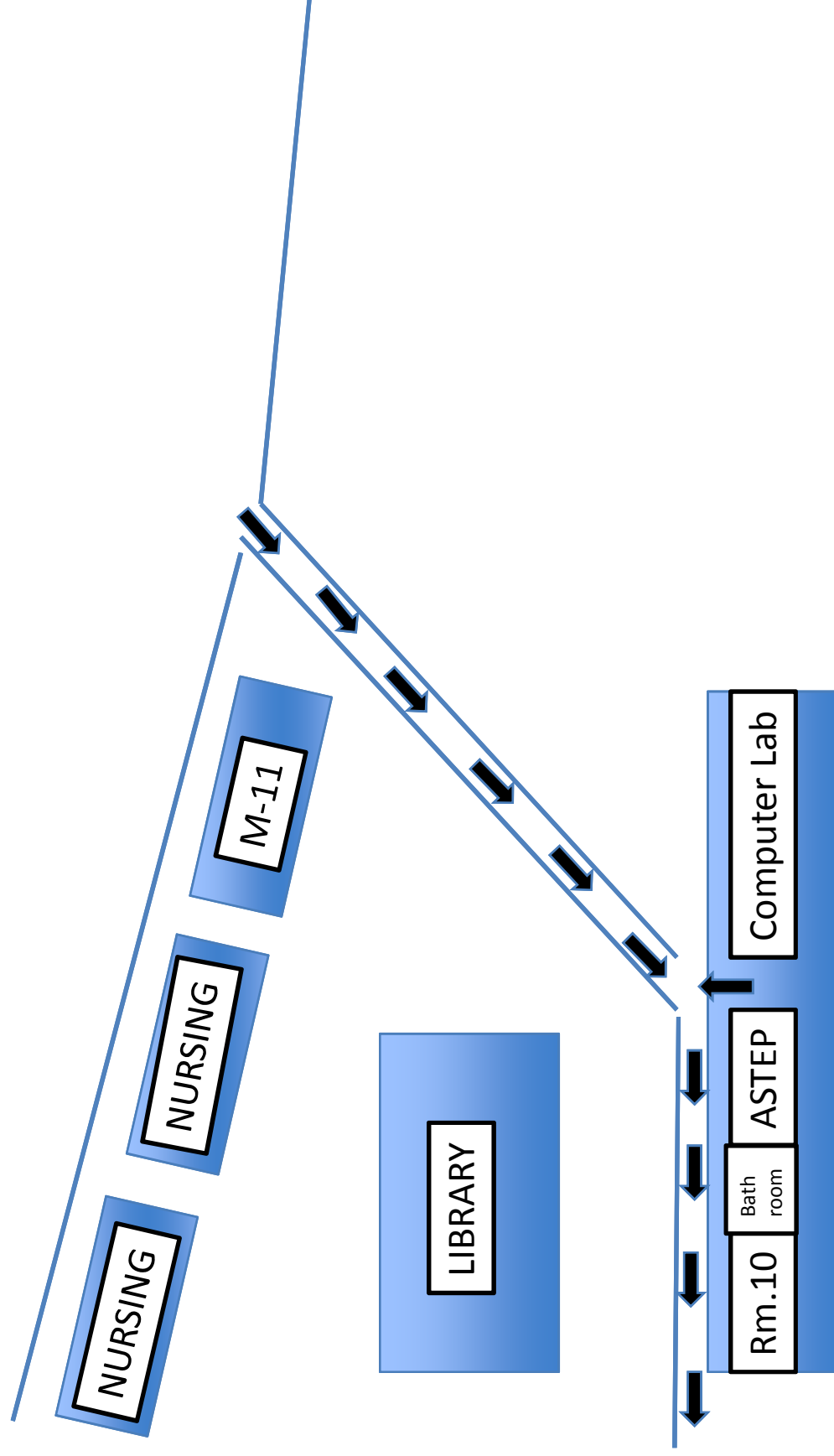

EVACUATION PROCEDURES

Evacuation from the Upper Housing

1. Proceed outside to the street area, moving to front entrance to housing.
2. Proceed to hillside sidewalks, directly to front parking lot.

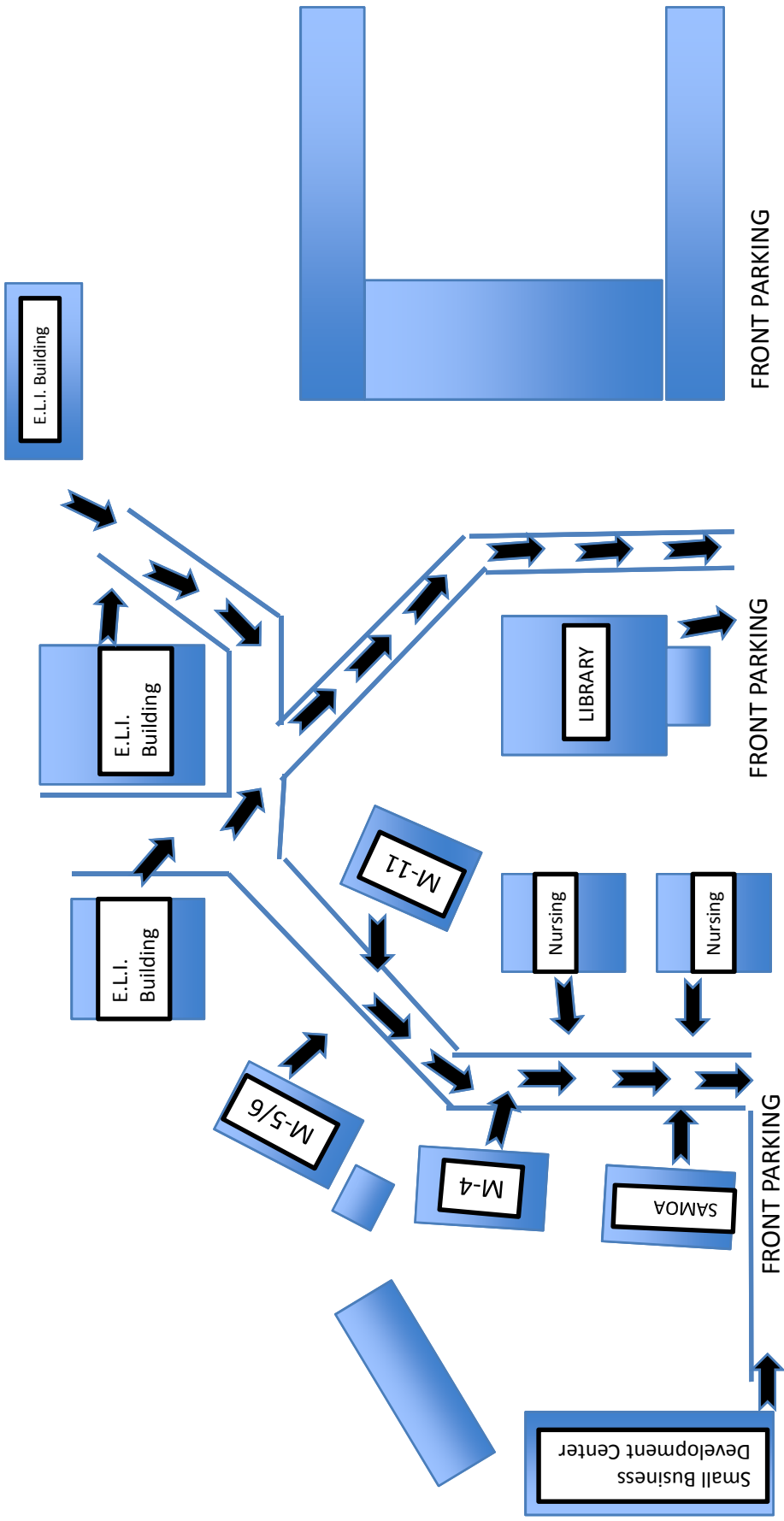

EVACUATION PROCEDURES

Evacuation Utility Road Offices

1. Proceed directly to the Malae Area.
2. Proceed to Gymnasium Parking Lot.

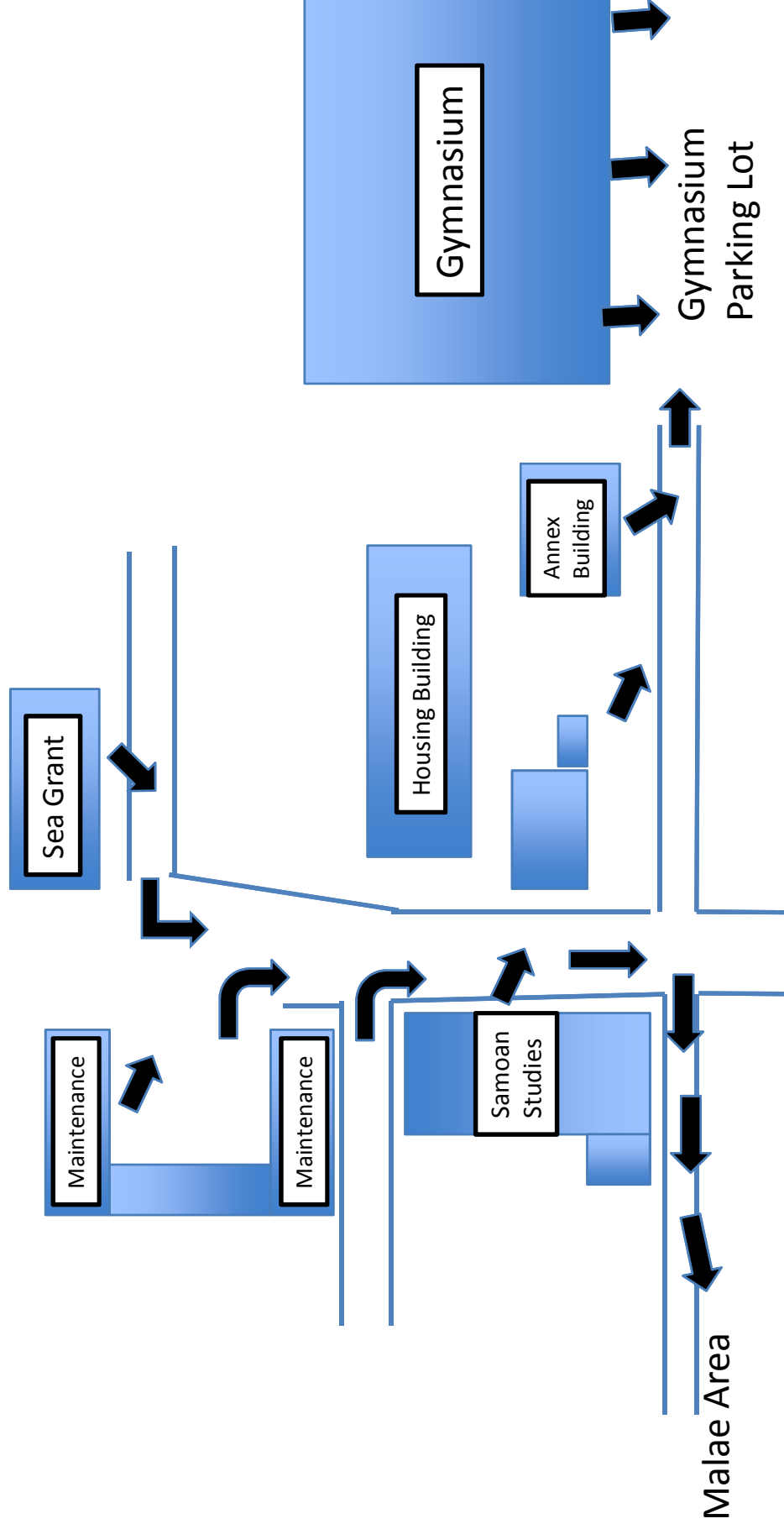

EVACUATION PROCEDURES

Evacuation from T & I Area

1. Proceed directly to the Malae Area.

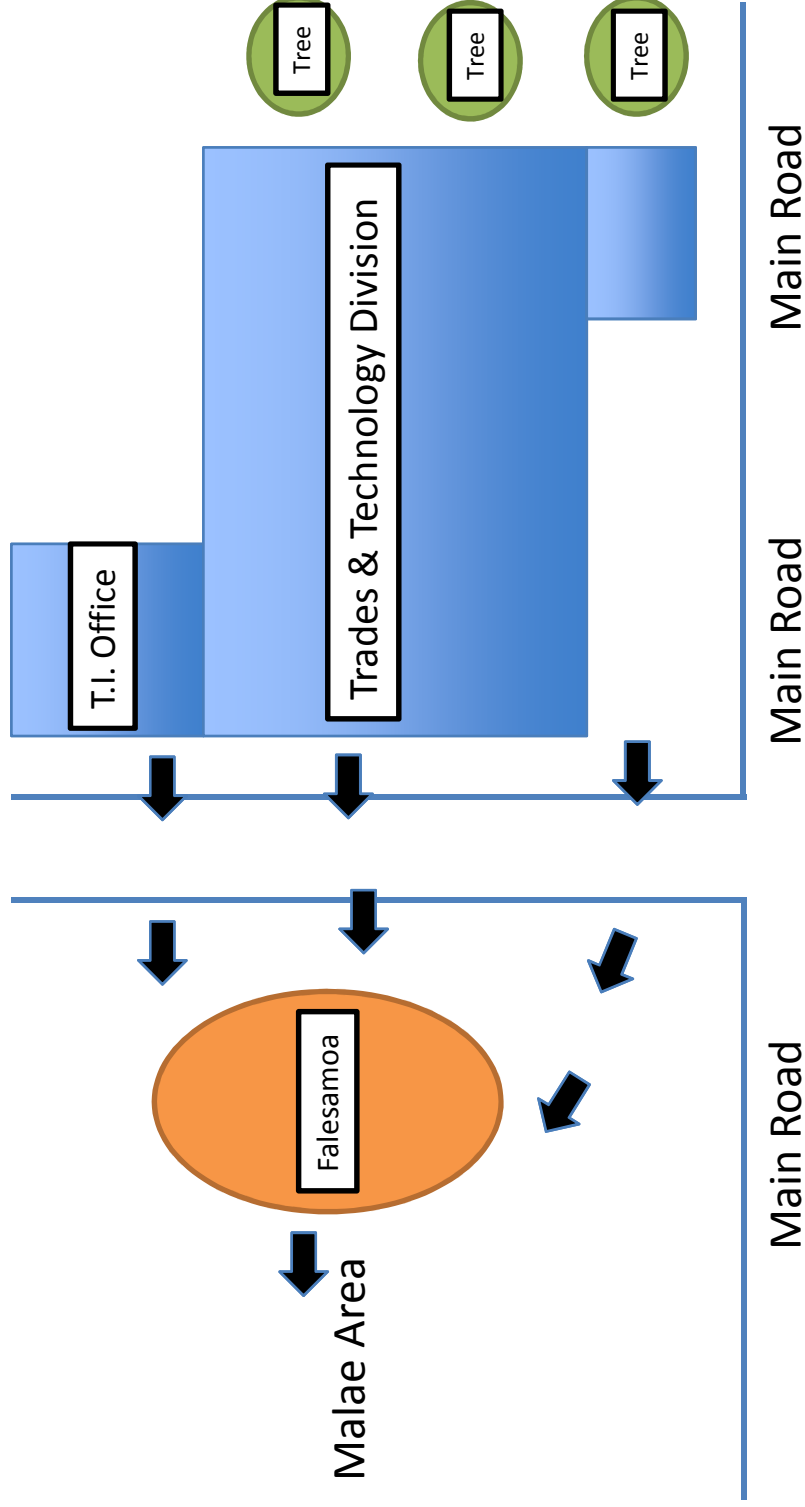

EVACUATION PROCEDURES

Evacuation from GYMNASIUM

1. Proceed directly to the Gym Parking Lot.
2. Proceed to through right sidewalk, directly to the Malae.

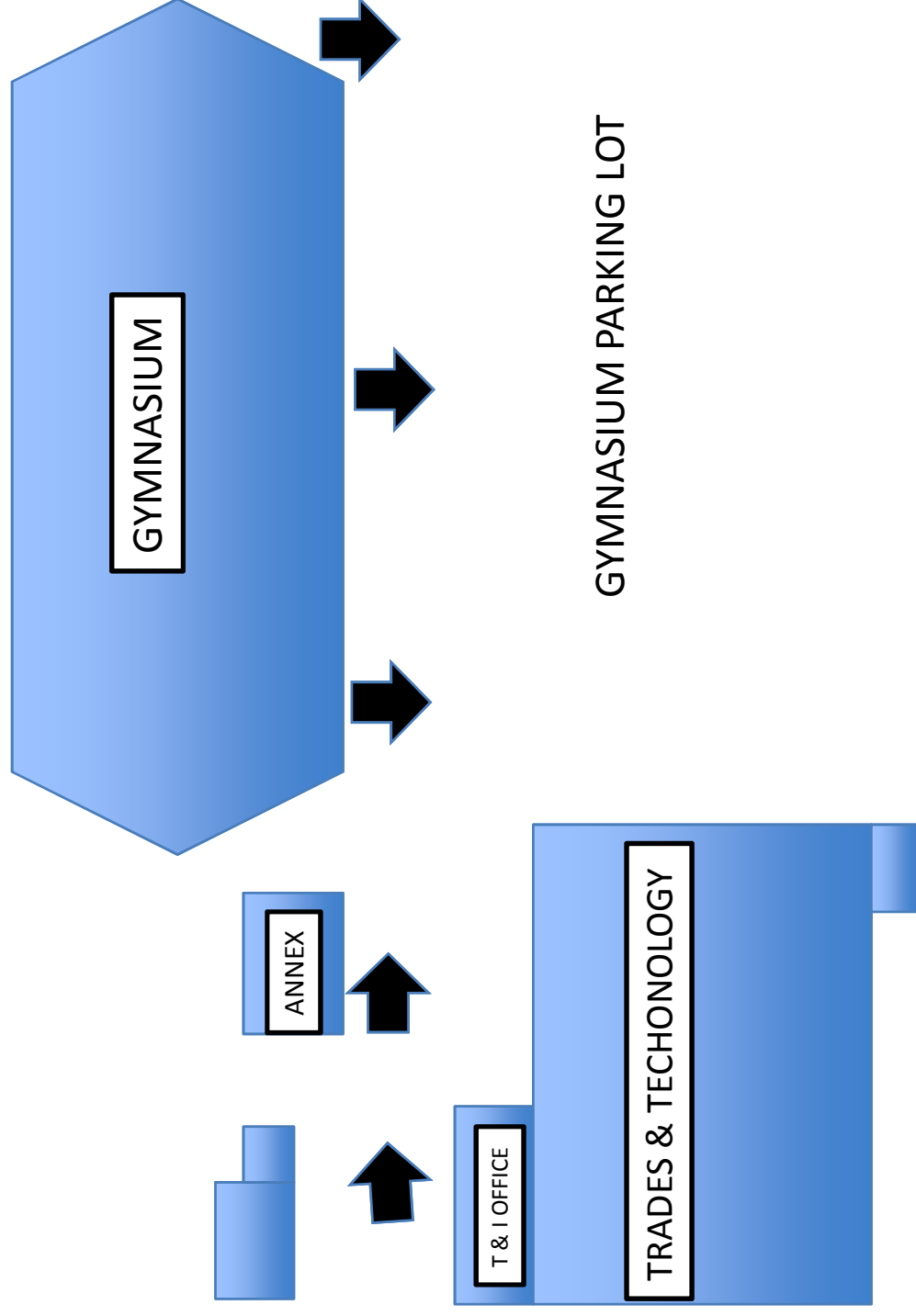

MALAEA AREA

EVACUATION PROCEDURES

Evacuation from COMMUNITY NATURAL RESOURCES/ CNR

1. Proceed to parking lot facing gymnasium.
2. Proceed to campus proper through housing road.

